



TIP-ON BLUMOTION

For TANDEMBOX plus, intivo & antaro

Easy opening combined with silent and effortless closing

INNOVATIVE TECHNOLOGY COMBINED WITH HIGH FUNCTIONALITY



Cabinet fronts with elegant furniture handles may be a popular and practiced trend. But we at Häfele would like to think ahead and extend the possibility of having smooth fronts without handles making way for an outstanding application in modern living environments. To make it easy to open such fronts, we bring to you the motion technology **TIP-ON BLUMOTION** from Blum, which combines the TIP-ON mechanical opening with the reliable BLUMOTION technology and ensures added convenience through a rounded motion and real usability. Having already introduced this into the LEGRABOX family last year, Häfele together with Blum now extends this motion technology to the more famous children of the Blum drawer systems: The TANDEMBOX Family.

The TIP-ON BLUMOTION technology opens drawer fronts with just a light touch in a smooth running action and closes them silently and effortlessly – allowing for a completely harmonious and flawless motion. The motion is assisted 100% mechanically and is the perfect solution for handle-less furniture in all living areas. It can be assembled quickly and simply without tools.

Compatible with all variants of **TANDEMBOX – plus, intivo and antaro** - the TIP-ON BLUMOTION motion technology is ideal for 30 kg and 65 kg systems. The four dimensional adjustments ensure an exact gap fit-out.

Topics	Page No.
▪ TIP ON BLUMOTION	3 - 4
▪ TANDEMBOX Optimisation	5
▪ TIP ON BLUMOTION - Components	6
▪ TIP ON BLUMOTION for TANDEMBOX	7
▪ TIP ON BLUMOTION for TANDEMBOX plus	8
▪ TIP ON BLUMOTION for TANDEMBOX plus Sink Cabinet	9
▪ TIP ON BLUMOTION for TANDEMBOX antaro	10
▪ TIP ON BLUMOTION for TANDEMBOX antaro Sink Cabinet	11
▪ TIP ON BLUMOTION for TANDEMBOX intivo	12
▪ TIP ON BLUMOTION for TANDEMBOX intivo Sink Cabinet	13
▪ Installation and Assembly	14 - 15
▪ Ordering Information	16 - 19

TIP-ON BLUMOTION : A New Motion Technology

The new motion technology combines the advantages of TIP-ON mechanical opening support system with the reliable BLUMOTION dampening for a silent and effortless closing. This advanced technology provides inspiration with its undeniable ease of use.

With TIP-ON BLUMOTION, it is possible to refine any design concept with well thought-out functionality – particularly if the design of the furniture avoids the use of handles completely.



A simple touch



The pull-out opens



A light push and it closes

TIP-ON BLUMOTION for TANDEMBOX

- > Dynamic load bearing capacities of 30 kg and 65 kg
- > Feather-light glide
- > Small minimum front gap of 2.5 mm
- > Extensive trigger range
- > Four-dimensional front adjustment

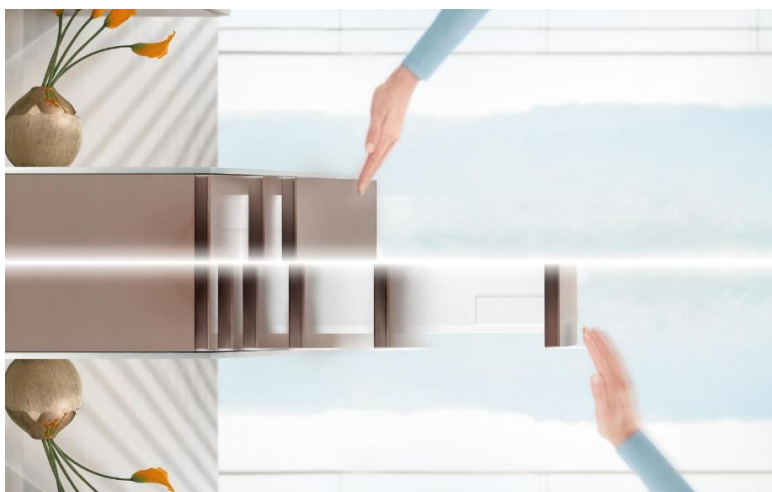

TIP-ON BLUMOTION : Extra Convenience with High Functionality

TIP-ON
BLUMOTION
by Blum

The TIP-ON mechanical opening support system combined with the soft-close BLUMOTION technology exhibits the following features:

**Small front gap with extensive trigger range**

TIP-ON BLUMOTION can be adjusted to have a small front gap of only 2.5 mm, therefore making it ideal for kitchens. In addition to this, Blum offers an optional synchronisation rod for wide and high fronts.

**Reliable function**

It is possible to pull open or manually push to close the drawer without difficulty. TIP-ON BLUMOTION is fully functional at all times and remains securely closed even if it has been pushed manually.

**Easy adjustment**

The 4-dimensional adjustment ensures a precise gap layout. The integrated depth adjustment can be made tool-free using the adjustment wheel incorporated into the TIP-ON BLUMOTION Unit.

TANDEMBOX optimisation

TIP-ON
BLUMOTION
by Blum

Optimised Feather-Light Glide:



Components in the drawer side and cabinet profile have been developed, perfecting the feather-light glide of TANDEMBOX and the smooth running action even further.

Easy Opening:



Lower opening forces and an even smoother transition to the feather-light glide, raise the level of convenience from the moment you open the pull-out.

Quality to the Touch:

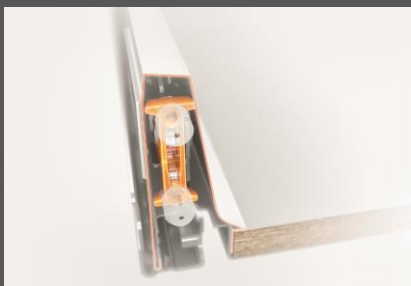

You can feel the increased stability provided by the combination of the optimised drawer side and new front fixing bracket.

TIP - ON BLUMOTION for TANDEMBOX

TIP-ON
BLUMOTION
by Blum

Component Details

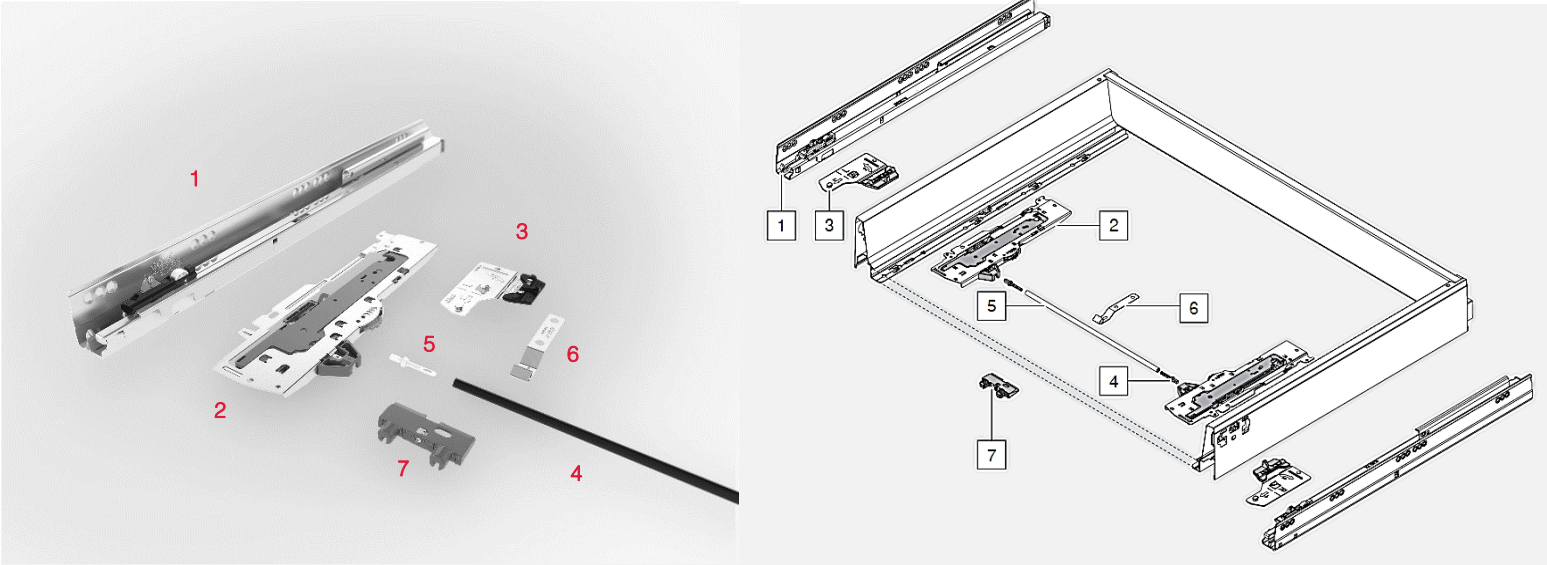

Key	BOM Component
1	TIP-ON BLUMOTION Cabinet Profile
2	TIP-ON BLUMOTION Unit
3	TIP-ON BLUMOTION Latch
4	TIP-ON BLUMOTION Round Synchronisation Linkage
5	TIP-ON BLUMOTION Synchronisation Adapter
6	TIP-ON BLUMOTION Support for Synchronisation Linkage
7	TIP-ON BLUMOTION Base Support Bracket

TIP-ON BLUMOTION Unit - The TIP-ON BLUMOTION units L3 and L5 are suitable for installation with all nominal lengths of 350 mm and higher.

TIP-ON BLUMOTION Units	Can be used for nominal length in mm
L3	350 – 650 (for 30 Kg)
L5	350 – 650 (for 65 Kg)

TIP-ON BLUMOTION Latch: The BLUMOTION latch is attached under the drawer and provides support to the drawer.

TIP-ON BLUMOTION Round Synchronisation Linkage: To achieve optimal functionality and to extend the trigger range of the TIP-ON BLUMOTION unit, a synchronization linkage is used.

TIP-ON BLUMOTION Synchronisation Adapter: The adapter connects the TIP-ON BLUMOTION unit to the TIP – ON BLUMOTION Synchronisation linkage.

TIP-ON BLUMOTION Support for Synchronisation Linkage: Prevents the synchronisation linkage from sagging, ultimately avoiding collision with the cabinet base.

TIP-ON BLUMOTION Base Support Bracket: Prevents the pull-out base from sagging, ultimately preventing the synchronisation linkage from colliding with the cabinet base.

TIP-ON BLUMOTION for TANDEMBOX plus, intivo and antaro

TIP-ON
BLUMOTION
by Blum

- > **TANDEMBOX plus** with its wide array of applications can be justifiably called the most versatile line. Its diversity offers freedom of design
- > For high fronted cabinet systems, it includes the application of *round* galleries (single or double*)

* BOMs for TANDEMBOX plus include only one gallery, the second gallery if required needs to be ordered separately



- > **TANDEMBOX intivo** lets the customer individualize and customize the range with design elements thereby making every interior unique
- > The customer can add a touch of grandeur to their kitchen by installing this box system



- > **TANDEMBOX antaro** distinguished by its clear style, is Häfele's minimalist line
- > It is characterized by rectangular galleries and includes an option of using design elements to achieve a closed side look*

* BOMs for TANDEMBOX antaro do not include the design element. It needs to be ordered separately.

TIP - ON BLUMOTION for TANDEMBOX plus



TANDEMBOX plus M Height Cabinet



M height cabinet (83.6 mm) comes with a load bearing capacity of 30 or 65 kg.

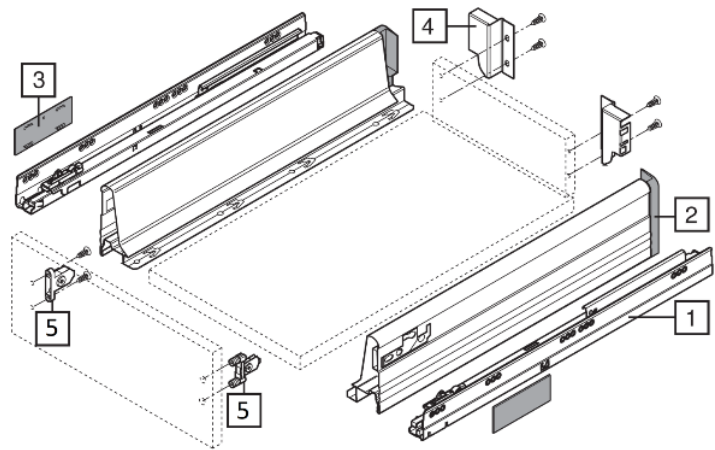

Key	BOM Component
1	Cabinet Profiles (Left and Right) compatible with TIP-ON BLUMOTION
2	Drawer Sides compatible with TIP-ON BLUMOTION
3	Cover Caps
4	Back Fixing Bracket (Left and Right)
5	Front Fixing Bracket

NOTE: TIP-ON BLUMOTION round synchronization linkage, TIP-ON BLUMOTION synchronisation adapter, TIP-ON BLUMOTION latch and the TIP-ON BLUMOTION units (L3 or L5) are included in the BOMs together with the individual components of TANDEMBOX plus.

TANDEMBOX plus D Height Cabinet

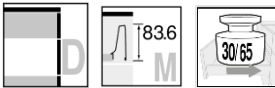

D height (M height drawer 83.6 mm + D back fixing bracket) cabinet comes with a load bearing capacity of 30 or 65 kg.

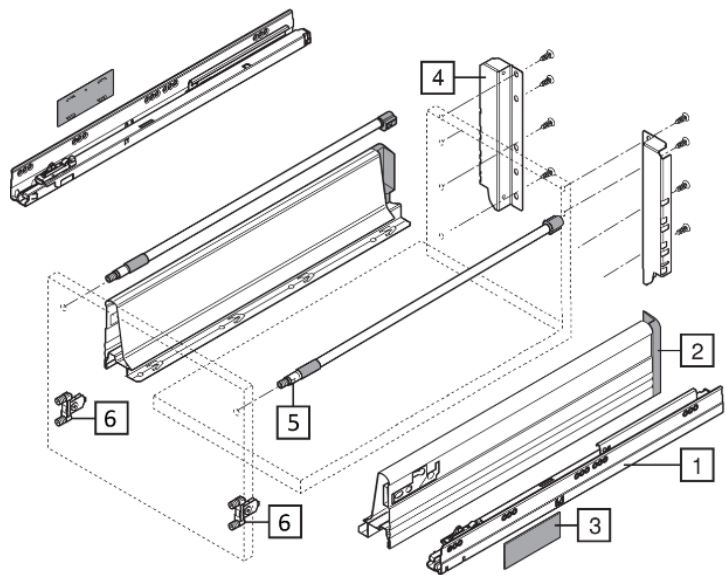

Key	BOM Component
1	Cabinet Profiles (Left and Right) compatible with TIP-ON BLUMOTION
2	Drawer Sides compatible with TIP-ON BLUMOTION
3	Cover Caps
4	Back Fixing Bracket (Left and Right)
5	Longside Gallery Rail
6	Front Fixing Bracket

NOTE: TIP-ON BLUMOTION round synchronization linkage, TIP-ON BLUMOTION synchronisation adapter, TIP-ON BLUMOTION latch and the TIP-ON BLUMOTION units (L3 or L5) are included in the BOMs together with the individual components of TANDEMBOX plus.

TIP - ON BLUMOTION for TANDEMBOX plus



TANDEMBOX plus Sink Cabinet

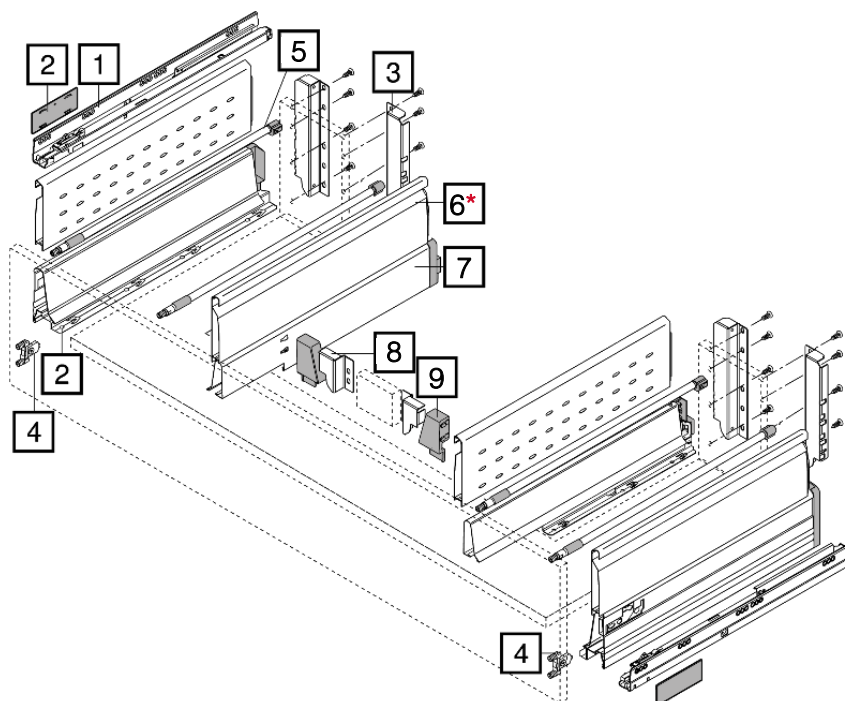

Key	BOM Component
1	Cabinet Profiles (Left and Right) compatible with TIP-ON BLUMOTION
2	Drawer Sides compatible with TIP-ON BLUMOTION
3	Back Fixing Bracket (Left and Right)
4	Front Fixing Bracket
5	Lateral Gallery Rail
6*	Double – wall BOXSIDE (Left/Right) i.e. the 6 th component do not form a part of the BOM and need to be ordered separately
7	Sink Drawer Side (Left/Right)
8	Sink Unit Brackets (Left/Right)
9	Sink Unit Adapter (Left/Right)

NOTE: TIP-ON BLUMOTION round synchronization linkage, TIP-ON BLUMOTION synchronisation adapter, TIP-ON BLUMOTION latch and the TIP-ON BLUMOTION units (L3 or L5) are included in the BOMs together with the individual components of TANDEMBOX plus.

TIP - ON BLUMOTION for TANDEMBOX intivo



TANDEMBOX intivo M Height Cabinet



M height cabinet (83.6 mm) comes with a load bearing capacity of 30 or 65 kg.

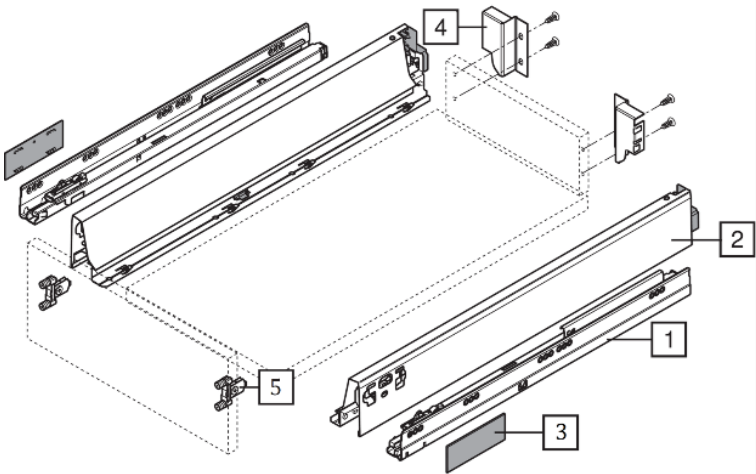

Key	BOM Component
1	Cabinet Profiles (Left and Right) compatible with TIP-ON BLUMOTION
2	Drawer Sides compatible with TIP-ON BLUMOTION
3	Cover Caps
4	Back Fixing Bracket (Left and Right)
5	Front Fixing Bracket

NOTE: TIP-ON BLUMOTION round synchronization linkage, TIP-ON BLUMOTION synchronisation adapter, TIP-ON BLUMOTION latch and the TIP-ON BLUMOTION units (L3 or L5) are included in the BOMs together with the individual components of TANDEMBOX intivo.

TANDEMBOX intivo D Height Cabinet



D height (L height drawer 101.4 mm + height of glass design element) cabinet with a load bearing capacity of 30 or 65 kg.

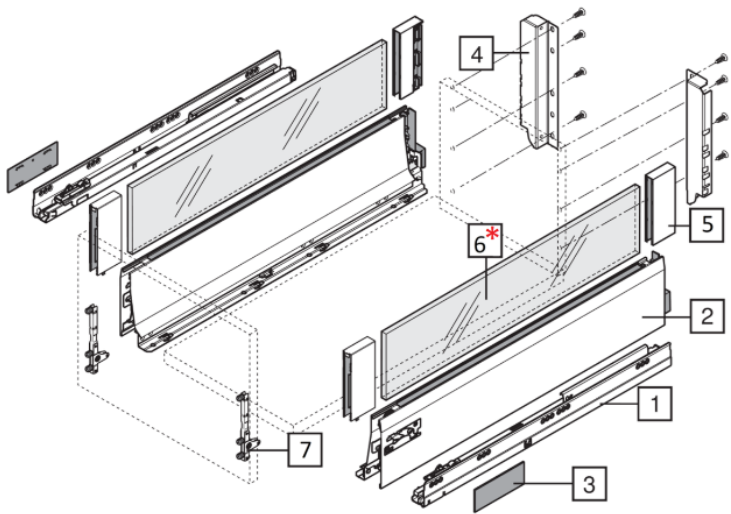

Key	BOM Component
1	Cabinet Profiles (Left and Right) compatible with TIP-ON BLUMOTION
2	Drawer Sides compatible with TIP-ON BLUMOTION
3	Cover Caps
4	Back Fixing Bracket (Left and Right)
5	Box Covers
6*	The Design Element i.e. the 6 th Component does not form a part of the BOM and needs to be ordered separately
7	Front Fixing Bracket

NOTE: TIP-ON BLUMOTION round synchronization linkage, TIP-ON BLUMOTION synchronisation adapter, TIP-ON BLUMOTION latch and the TIP-ON BLUMOTION units (L3 or L5) are included in the BOMs together with the individual components of TANDEMBOX intivo.

TIP - ON BLUMOTION for TANDEMBOX intivo



TANDEMBOX intivo Sink Cabinet

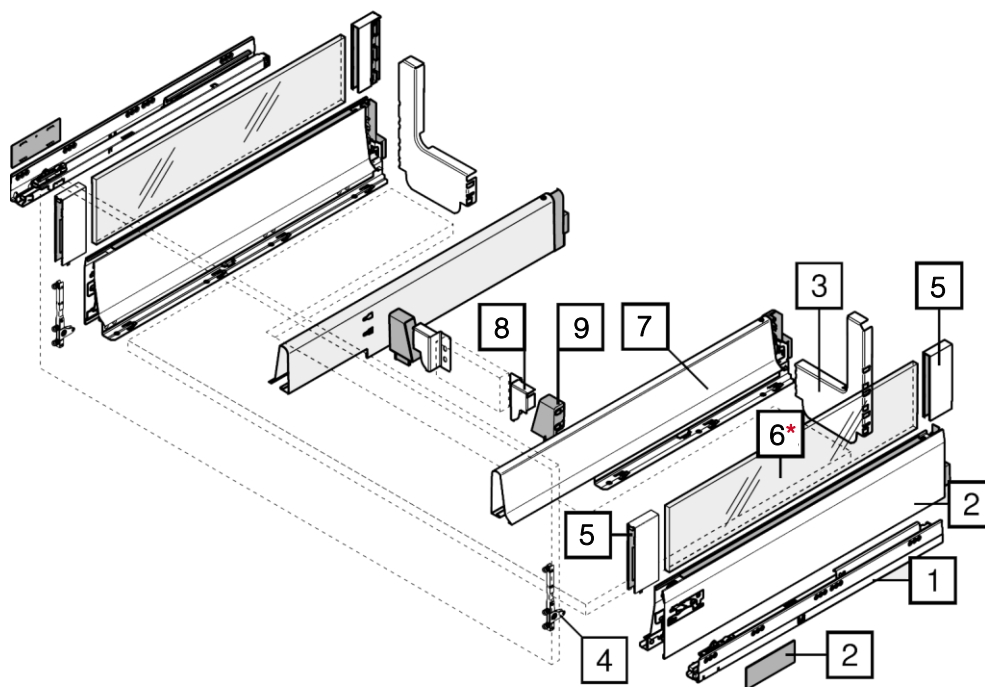

Key	BOM Component
1	Cabinet Profiles (Left and Right) compatible with TIP-ON BLUMOTION
2	Drawer Sides compatible with TIP-ON BLUMOTION
3	Steel Back L- Shape (Left/Right)
4	Front Fixing Bracket
5	BOXCOVER (Left/Right)
6*	Glass design element (Side) i.e. the 6 th Component does not form a part of the BOM and needs to be ordered separately
7	Sink Drawer Side (Left/Right)
8	Sink Unit Brackets (Left/Right)
9	Sink Unit Adapter (Left/Right)

NOTE: TIP-ON BLUMOTION round synchronization linkage, TIP-ON BLUMOTION synchronisation adapter, TIP-ON BLUMOTION latch and the TIP-ON BLUMOTION units (L3 or L5) are included in the BOMs together with the individual components of TANDEMBOX intivo.

TIP - ON BLUMOTION for TANDEMBOX antaro



TANDEMBOX antaro M Height Cabinet



M height cabinet (83.6 mm) comes with a load bearing capacity of 30 or 65 kg.

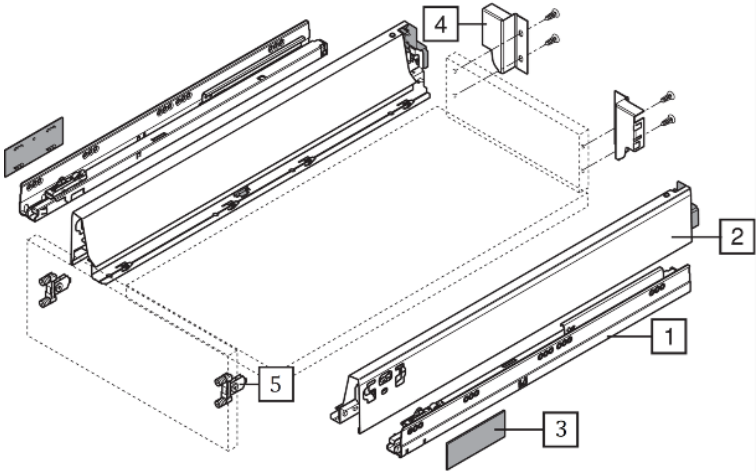

Key	BOM Component
1	Cabinet Profiles (Left and Right) compatible with TIP-ON BLUMOTION
2	Drawer Sides compatible with TIP-ON BLUMOTION
3	Cover Caps
4	Back Fixing Bracket (Left and Right)
5	Front Fixing Bracket

NOTE: TIP-ON BLUMOTION round synchronization linkage, TIP-ON BLUMOTION synchronisation adapter, TIP-ON BLUMOTION latch and the TIP-ON BLUMOTION units (L3 or L5) are included in the BOMs together with the individual components of TANDEMBOX antaro.

TANDEMBOX antaro D Height Cabinet

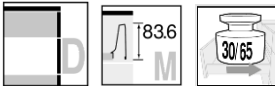

D height (M height drawer 83.6 mm + height of glass design element + height of gallery) cabinet comes with a load bearing capacity of 30 or 65 kg.

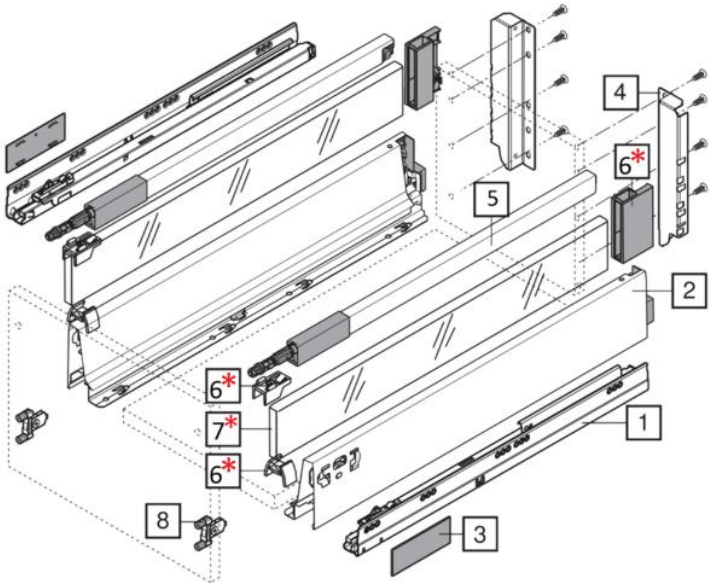

Key	BOM Component
1	Cabinet Profiles (Left and Right) compatible with TIP-ON BLUMOTION
2	Drawer Sides compatible with TIP-ON BLUMOTION
3	Cover Caps
4	Back Fixing Bracket (Left and Right)
5	Longside Gallery Rail
6	The Locking Piece Set and the Design Element i.e. the 6 th and 7 th Component respectively do not form a part of the BOM and need to be ordered separately
7	
8	Front Fixing Bracket

NOTE: TIP-ON BLUMOTION round synchronization linkage, TIP-ON BLUMOTION synchronisation adapter, TIP-ON BLUMOTION latch and the TIP-ON BLUMOTION units (L3 or L5) are included in the BOMs together with the individual components of TANDEMBOX antaro.

TIP - ON BLUMOTION for TANDEMBOX intivo



TIP-ON
BLUMOTION
by Blum

TANDEMBOX antaro Sink Cabinet

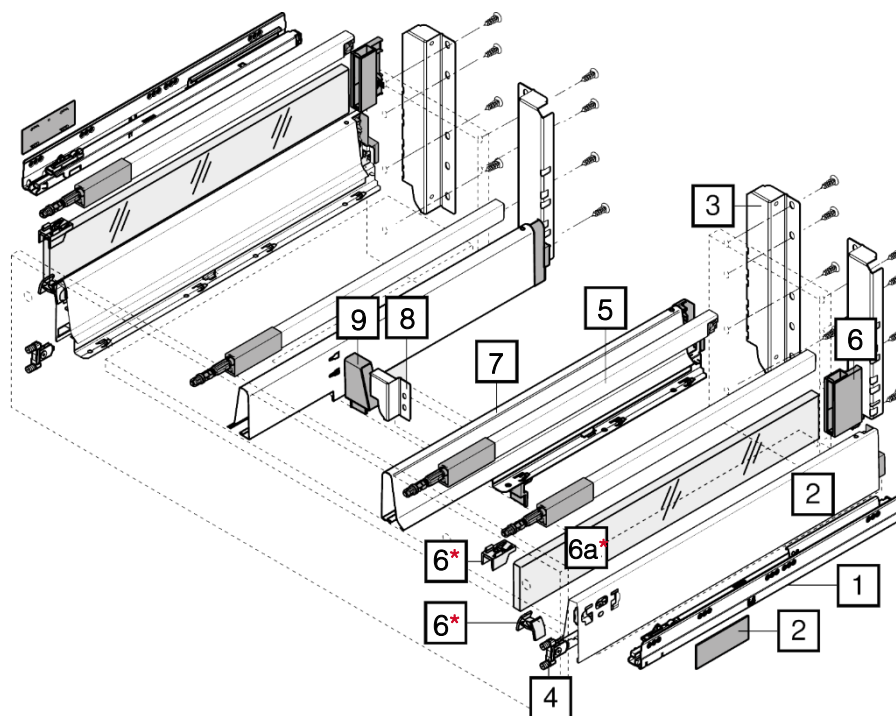

Key	BOM Component
1	Cabinet Profiles (Left and Right) compatible with TIP-ON BLUMOTION
2	Drawer Sides compatible with TIP-ON BLUMOTION
3	Back Fixing Bracket (Left and Right)
4	Front Fixing Bracket
5	Longside Gallery Rail (Left/Right)
6*	The Locking Piece Set and the Design Element i.e. the 6 th and 6a component respectively do not form a part of the BOM and need to be ordered separately
6a*	
7	Sink Drawer Side (Left/Right)
8	Sink Unit Brackets (Left/Right)
9	Sink Unit Adapter (Left/Right)

NOTE: TIP-ON BLUMOTION round synchronization linkage, TIP-ON BLUMOTION synchronisation adapter, TIP-ON BLUMOTION latch and the TIP-ON BLUMOTION units (L3 or L5) are included in the BOMs together with the individual components of TANDEMBOX antaro.

TIP-ON BLUMOTION for TANDEMBOX

TIP-ON
BLUMOTION
by Blum

Installation and Assembly

1 Space requirements in the cabinet – drawer

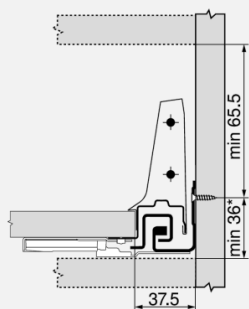

Space requirements in the cabinet – inner drawer

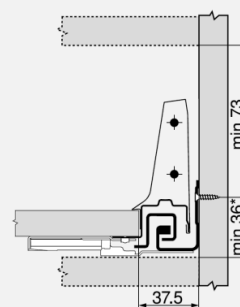

NOTE: The space requirement for TIP-ON BLUMOTION is different to that for BLUMOTION, lowest drilling position for the cabinet profile increases to at least 36 mm

2 Easy Assembly and Adjustment: Tool-free assembly of the latch on the cabinet profile and the TIP-ON BLUMOTION unit on the drawer side

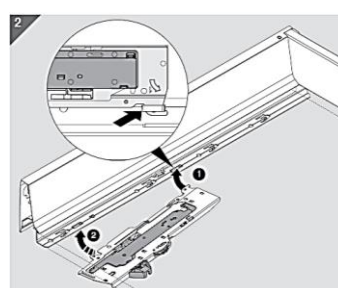
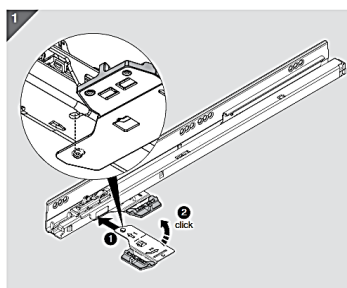

3 Synchronisation: The motion is improved through the use of TIP-ON BLUMOTION Synchronisation linkage

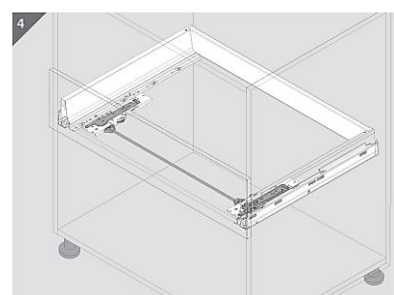
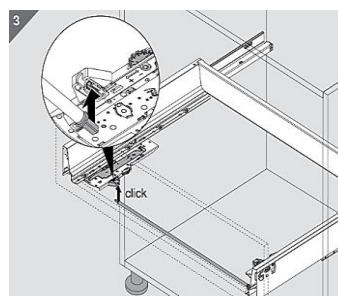
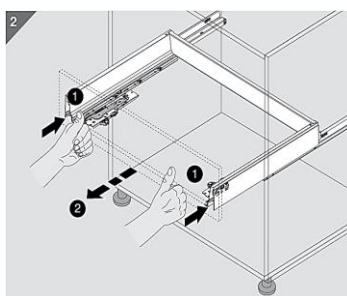

TIP-ON BLUMOTION for TANDEMBOX

TIP-ON
BLUMOTION
by Blum

Installation and Assembly

4 Support for Synchronisation Linkage Drilling Position

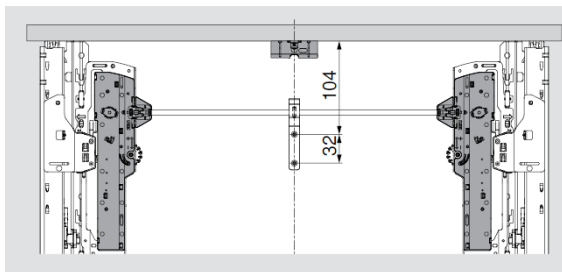

4 - Dimensional Adjustment Options

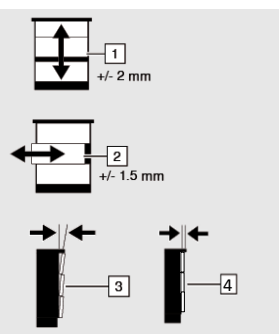
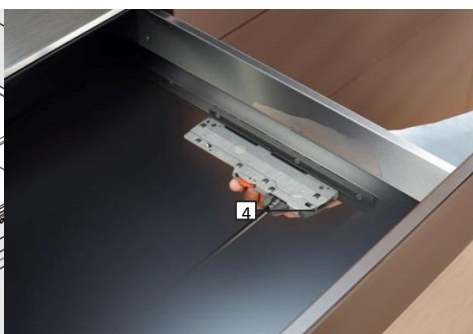
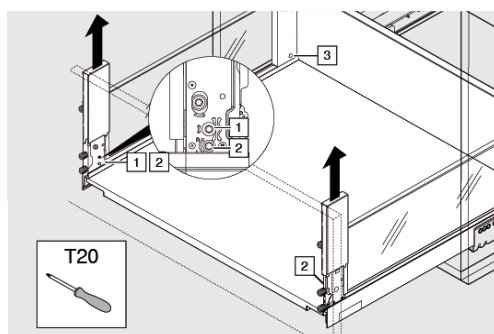

1 Height Adjustment

2 Side Adjustment

3 Tilt Adjustment

4 Depth Adjustment

Height and side adjustment

At the front of the exterior drawer side.

- > Height adjustment +/- 2 mm
- > Side adjustment +/- 1 mm

Tilt adjustment

For pull-outs, on the gallery
(For TANDEMBOX intivo this adjustment can be done on the exterior drawer side)

Depth adjustment

The integrated depth adjustment is carried out tool-free using the adjustment wheel incorporated into the TIP-ON BLUMOTION Unit.

- > Minimum front gap 2.5 mm
- > Factory setting 2.5 mm
- > Adjustment range -1/+2 mm





ORDERING INFORMATION : BOM ARTICLE

Article No	Product Image	Colour	Nominal Length	MRP(INR)
Drawer Systems				
TANDEMBOX plusM – Height; 30 Kg				
554.88.770		White	450 mm	5,878/-
554.88.771			500 mm	5,878/-
554.88.772			550 mm	6,180/-
554.88.270		Grey	450 mm	5,878/-
554.88.271			500 mm	5,878/-
554.88.272			550 mm	6,180/-
554.88.070		Stainless Steel	450 mm	8,702/-
554.88.071			500 mm	8,846/-
554.88.072			550 mm	9,247/-
TANDEMBOX plusD – Height; 30 Kg				
554.88.773		White	450 mm	6,381/-
554.88.774			500 mm	6,381/-
554.88.775			550 mm	6,684/-
554.88.273		Grey	450 mm	6,381/-
554.88.274			500 mm	6,381/-
554.88.275			550 mm	6,684/-
554.88.073		Stainless Steel	450 mm	10,190/-
554.88.074			500 mm	10,424/-
554.88.075			550 mm	10,786/-
TANDEMBOX plusD – Height; 65 Kg				
554.88.776		White	500 mm	7,690/-
554.88.777			550 mm	7,992/-
554.88.276		Grey	500 mm	7,690/-
554.88.277			550 mm	7,992/-
554.88.076		Stainless Steel	500 mm	11,422/-
554.88.077			550 mm	11,856/-
TANDEMBOX intivoM – Height; 30 Kg				
551.24.770		White	450 mm	6,246/-
551.24.771			500 mm	6,411/-
551.24.772			550 mm	6,584/-
551.24.070		Stainless Steel	450 mm	8,649/-
551.24.071			500 mm	9,199/-
551.24.072			550 mm	9,215/-

ORDERING INFORMATION : BOM ARTICLE

Article No	Product Image	Colour	Nominal Length	MRP(INR)
Drawer Systems				
TANDEMBOX intivo		D – Height; 30 Kg		
551.24.773		White	450 mm	8,432/-
551.24.774			500 mm	9,017/-
551.24.775			550 mm	9,126/-
551.24.073		Stainless Steel	450 mm	11,431/-
551.24.074			500 mm	11,784/-
551.24.075			550 mm	11,863/-
TANDEMBOX intivo		D – Height; 65 Kg		
551.24.776		White	500 mm	9,284/-
551.24.777			550 mm	9,463/-
551.24.076		Stainless Steel	500 mm	11,946/-
551.24.077			550 mm	12,468/-
TANDEMBOX antaro		M – Height; 30 Kg		
551.24.770		White	450 mm	6,246/-
551.24.771			500 mm	6,411/-
551.24.772			550 mm	6,584/-
551.24.270		Grey	450 mm	5,804/-
551.24.271			500 mm	6,082/-
551.24.272			550 mm	6,256/-
551.24.070		Stainless Steel	450 mm	8,649/-
551.24.071			500 mm	9,199/-
551.24.072			550 mm	9,215/-
TANDEMBOX antaro		D – Height; 30 Kg		
551.24.778		White	450 mm	7,096/-
551.24.779			500 mm	7,358/-
551.24.780			550 mm	7,843/-
551.24.273		Grey	450 mm	7,096/-
551.24.274			500 mm	7,308/-
551.24.275			550 mm	7,794/-
551.24.078		Stainless Steel	450 mm	10,757/-
551.24.079			500 mm	11,313/-
551.24.080			550 mm	11,424/-
TANDEMBOX antaro		D – Height; 65 Kg		
551.24.781		White	500 mm	8,144/-
551.24.782			550 mm	8,437/-
551.24.276		Grey	500 mm	7,763/-
551.24.277			550 mm	8,330/-
551.24.081		Stainless Steel	500 mm	11,603/-
551.24.082			550 mm	12,237/-

ORDERING INFORMATION : BOM ARTICLE

BOM Article No.	Product Image	Colour	MRP(INR)
Sink Unit of 500 mm			
TANDEMBOX plus			
D – Height; 30 Kg			
554.81.040		Stainless Steel	25,937/-
554.81.340		Grey	15,944/-
554.81.620		White	15,736/-
TANDEMBOX plus			
D – Height; 65 Kg			
554.81.030		Stainless Steel	30,844/-
554.81.330		Grey	15,961/-
554.81.640		White	14,873/-
TANDEMBOX intivo			
D – Height; 30 Kg			
554.81.110		Stainless Steel	27,246/-
554.81.611		White	19,745/-
TANDEMBOX intivo			
D – Height; 65 Kg			
554.81.139		Stainless Steel	25,022/-
554.81.639		White	20,246/-
TANDEMBOX antaro			
D – Height; 30 Kg			
554.81.064		Stainless Steel	18,949/-
554.81.320		Grey	12,026/-
551.81.620		White	12,026/-

ORDERING INFORMATION : BOM ARTICLE

BOM Article No.	Product Image	Colour	MRP(INR)
Sink Unit of 500 mm			
TANDEMBOX antaro D – Height; 65 Kg			
554.81.164		Stainless Steel	19,900/-
554.81.364		Grey	12,784/-
554.81.664		White	12,784/-



HÄFELE

Häfele India Private Limited | Office No. 3, Building “A”, BETA, I Think Techno Campus, Off J.V.L.R, Opp. Kanjurmarg East, Mumbai – 400 042. | Tel.: 022 6142 6100 | Fax: 022 6702 0531
New Delhi | Kolkata | Chennai | Hyderabad | Bangalore | Pune | Ahmedabad | Srilanka | Bangladesh | Nepal| Bhutan

Toll Free Customer Care No.:1800 266 6667 | SMS HAFELE to 56070 | customercare@hafeleindia.com
www.hafeleindia.com