

HYDRAULIC PATCH FITTINGS

FOR GLASS, WOODEN AND WOODEN FRAMED DOORS

The sheer transparency and elegance of glass radiates a luxurious aura. Similarly, a seamless plank of wood exudes classiness and style. Hardware that does not hamper this innate sophistication is therefore gaining importance. Hafele brings to you its new and improved range of Hydraulic Patch Fittings which supports this trend of minimal, understated aesthetics as well as provides the right functionality. This range for frameless glass, wooden and wooden framed doors comes with a high load bearing capacity of 100 kg., requires no floor excavation for installation and is engineered for stability and durability.



No excavation required: Hafele's Hydraulic Patch Fittings do not require any cavity in floor to install hence no digging or cutting of the floor is required, making the installation quick & easy.

Compact fitting: These fittings come with a sleek build thus imparting a minimalistic look to overall door construction.

Durability: The new hydraulic patch fittings are tested for 3,00,000 cycles.

Adjustments: Both the fittings from this range come with adjustable closing and latching speeds.

PRODUCT SPECIFICATIONS



Article number	931.46.255	931.46.256
Application	For frameless glass doors	For wooden and wooden framed doors
Max. door width	1000 mm	1000 mm
Max. door weight	100 kg.	100 kg.
Door thickness	8 – 13 mm	Min. 40 mm
Max. opening angle	170°	150°
Dimensions	181 (W) x 44 (D) x 70 (H)	181 (W) x 47 (D) x 110 (H)
Hold open angle	90°	
Closing force	Size 3	
Cover plate material	Stainless steel grade 304	
Finish	Satin stainless steel	Anodised Aluminium
Tested for	3,00,000 cycles	
Mounting	Floor mounted by surface fixing (non-excavating)	
Adjustment	Adjustable closing and latching speed	

FUNCTIONING

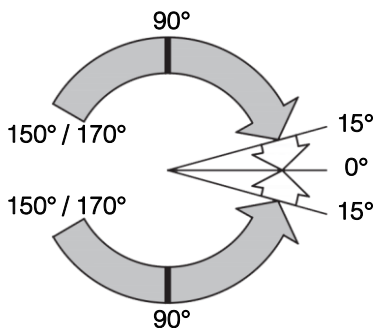

150° - 15° / 170° - 15°*	Closing speed adjustable by Valve 1
15° - 0°	Latching speed adjustable by Valve 2
90°	Hold open

* Opening angle of Hydraulic Patch Fitting for frameless glass doors is 170° and for wooden or wooden framed doors is 150°

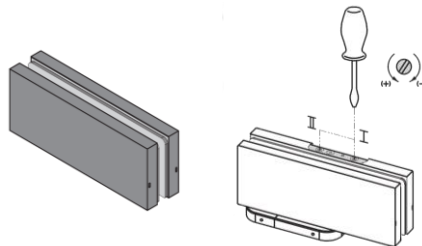

Hydraulic Patch Fitting for Glass Doors

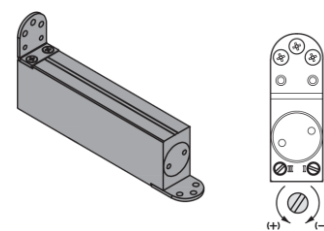

Hydraulic Patch Fitting for Wooden & Wooden Framed Doors

GLASS CUT-OUT DETAIL FOR 931.46.255

